

# Power supply

## 12 VDC / 1.25 A power supply



Model number:	<b>PS-15-12</b>
Mounting:	DIN rail
Dimensions:	93 x 25 x 56 mm

## Highlights & Features

- Universal AC input voltage and full power up to 50°C
- Efficiency > 84.0% @ 230Vac

## Technical specification

Input voltage range	85 - 264 VAC
Output voltage	12 VDC
Output current	1.25 A
Rated Current	15W
Voltage adj. range	+/-10%
Voltage tolerance	+/-1%
Input current	0.65A @ 230Vac
Operating temperature	-20°C to +50°C; 20% to 90% RH
Storage temperature	-40°C to +85°C; 10% to 95% RH Non condensing

## Dimensions

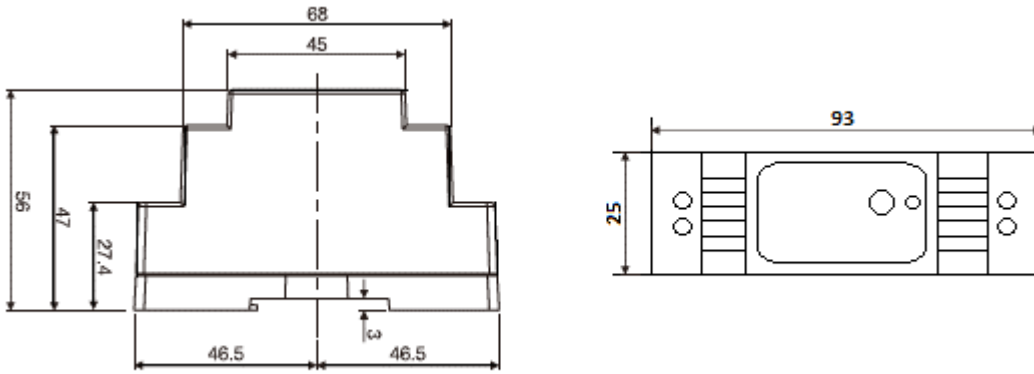

## Safety Standards

- UL60950-1
- TUV EN60950-1
- EN50178

From:  
<https://wiki.hiq-home.com/> -

Permanent link:  
[https://wiki.hiq-home.com/doku.php?id=en:ms\\_main:ps-15-12&rev=1618835502](https://wiki.hiq-home.com/doku.php?id=en:ms_main:ps-15-12&rev=1618835502)

Last update: **2021/04/19 12:31**

