

# Power supply

## 24 V DC / 2.5 A power supply



Model number:	<b>PS-60-24</b>
Mounting:	DIN rail
Dimensions:	93 x 78 x 56 mm

## Highlights & Features

- Universal AC input voltage and full power up to 50°C
- Efficiency > 84.0% @ 230Vac

</WRAP>

## Technical specification

Input voltage range	90 - 264 VAC
Output voltage	24 VDC
Output current	2.50 A
Input current	0.65A @ 230Vac
Efficiency	84%
Operating temperature	-20°C to +50°C; 20% to 90% RH
Storage temperature	-40°C to +85°C; 10% to 95% RH Non condensing

## Dimensions

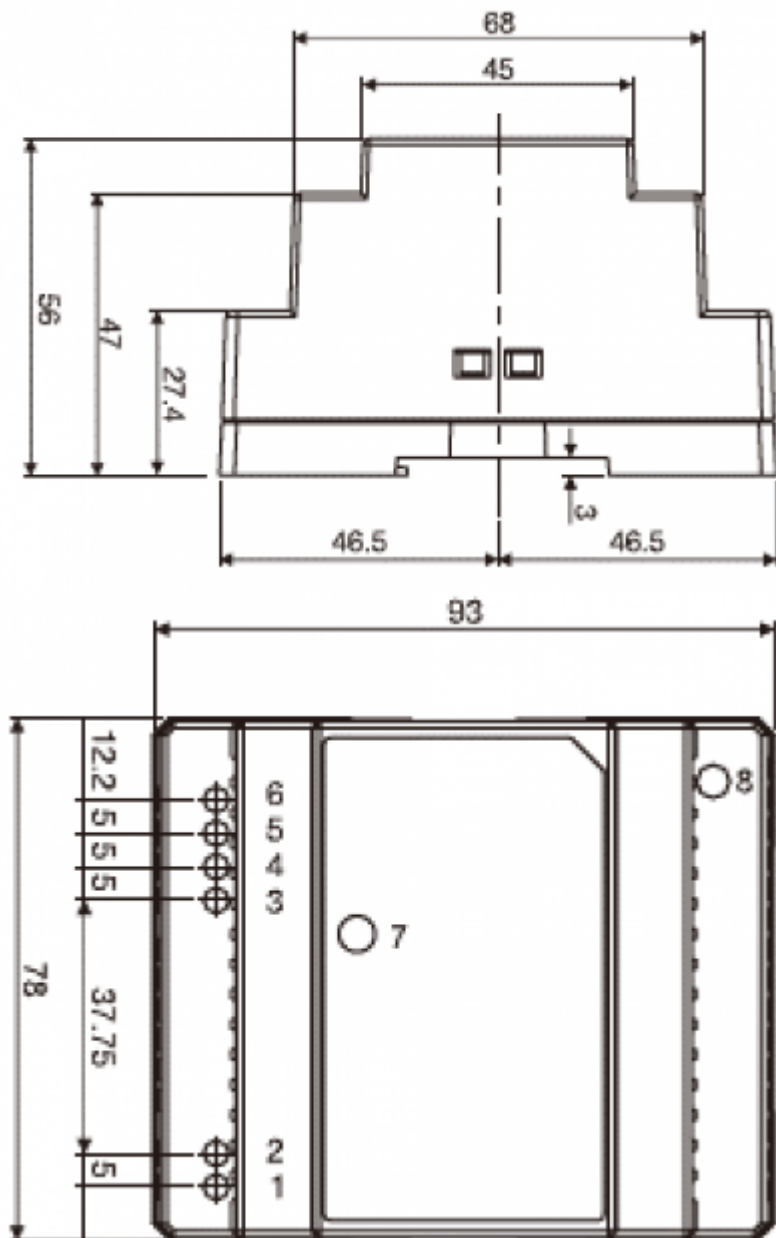

## Pin assignment

Pin NO.	Assignment	Pin NO.	Assignment
1	AC/L	5,6	+V
2	AC/N	7	LED
3,4	-V	8	+V ADJ.

From: <http://wiki.hiq-home.com/> -

Permanent link: [http://wiki.hiq-home.com/doku.php?id=en:ms\\_main:ps-60-24&rev=1610365469](http://wiki.hiq-home.com/doku.php?id=en:ms_main:ps-60-24&rev=1610365469)

Last update: 2021/01/11 11:44



