

USER MANUAL

RELAY SWITCH BC-WE-F1

Power supply: 230V AC 50Hz
Switching capabilities: 230V AC – 3A
Consumption: < 1W
Max. Engine Power: 280W, 60Nm Max
Radio frequency range: 868.0 to 868.6 Mhz
RF power Max: +3dBm
Range: up to 30m indoor
Operational temperature: -10°C to 40°C
Protection rating: IP 30
Pairing: up to 22 controllers
EPP (EnOcean Profile): D2-05-00
Dimensions: 40mm x 44mm x 16.9mm
Weight: 34g
Warranty: 2 years

DANGER OF ELECTROCUTION



BEFORE ANY INSTALLATION MAKE SURE THE POWER SUPPLY IS DISCONNECTED TO AVOID ANY RISK OF ELECTROCUTION

USE CAUTIONS

Never use the device if it is not correctly installed and placed inside a connecting box in conformity with the current norms.

Keep the product far away from liquids.



This product must be used indoor only



This product is conform to EnOcean radio protocol



INSTALLATION

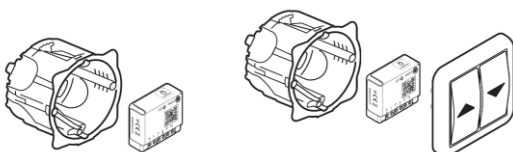

Thanks to its small size, the Relay Switch can be installed in a connecting box or behind the wall switch which controls the roller shutter or motorized awning.

RELAY SWITCH INPUT/OUTPUT



N	Terminal for the Neutral
L	Terminal for the Line
I+	Input terminal for the wired switch "up"
I-	Input terminal for the wired switch "down"
▲ (M)	Engine output terminal "up"
▼ (M)	Engine output terminal "down"

Each terminal can accept a cable of 2.5mm² maximum, stripped of 8mm.

INSTALLATION DIAGRAM

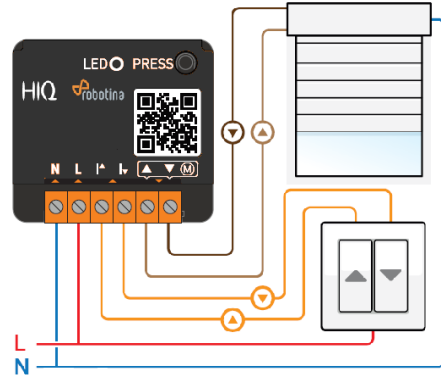

AUTO-DETECTION OF SWITCH TYPE

After turning the power supply ON, do a single push on the wired wall switch. The relay switch has an auto-detection system to automatically detect the type of wired wall switch (rocker or push-button) wired at the input.

Note: The same configuration is applied for both inputs I+ and I-. It is not possible to combine a rocker switch with a push-button. To perform a new auto-detection, the Relay switch must be manually reset. (see reset procedure)

CALIBRATION OF THE RELAY SWITCH BC-WE-F1

Two modes

- From the Relay Switch



Note: The Relay Switch LED blinks green, meaning the calibration has well started.

- From the wired wall switch

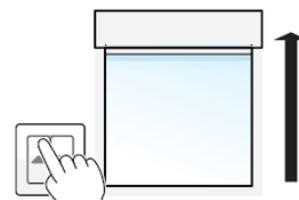

Put the roller shutter/awning in position up.

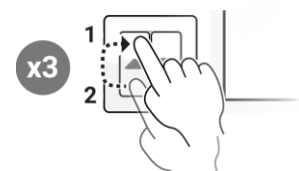

Do 3 times the cycle "up - stop" with the wired wall switch.

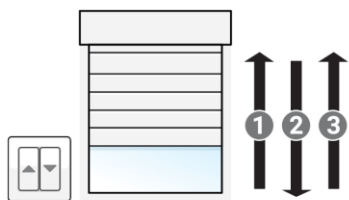

Cancel the calibration:
Perform 5 brief presses. From the wired switch, press once on the switch.

The roller shutter/awning confirms the auto-calibration by performing a complete cycle "up/down/up"**.

** If the cycle is reversed (down/up/down), switch ▲(M) and ▼(M)

PAIRING PROCEDURE

To add a remote or wall switch or the Soft button (EnOcean compatible) you must enter the pairing mode, your light must be switched OFF. Relay must be power supplied.

Two modes

1. From the Relay Switch



Launch the pairing by doing 3 consecutive presses on the relay switch button. The LED blinks red.

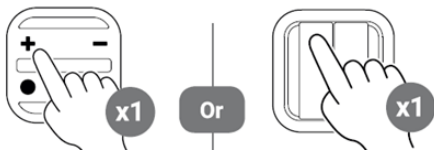

You have now 30 seconds to pair your controller by briefly pressing on the button of your choice, this one will control the rise of your roller shutter/awning.



You have now 30 seconds to pair your Soft button by doing 5 brief consecutive presses on the button.



The LED of the relay switch will blink green twice, confirming the pairing.

NOTE: if the LED blinks orange during the pairing procedure, it means that more than 22 controllers are paired. You must remove one controller to add a new one.

2. From the wired wall switch

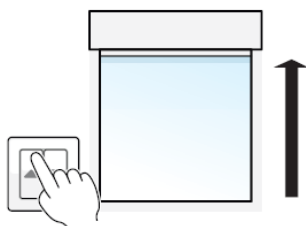

Put the roller shutter/awning in position up.

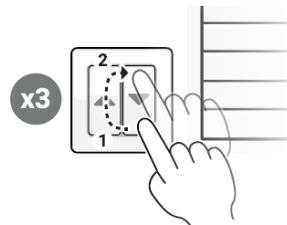

Do 3 times the cycle »down-stop« with the wired wall switch.

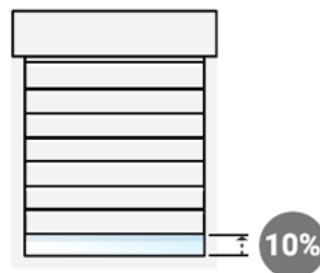

The roller shutter/awning will rise of 10%.

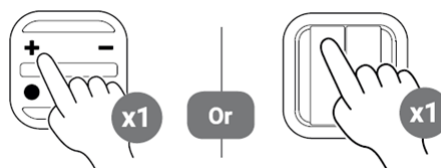

You have now 30 seconds to pair your controller by briefly pressing on the button of your choice, this one will control the rise of your roller shutter/awning.

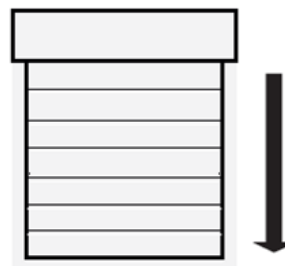

The roller shutter/awning confirms the pairing by closing completely.

UNPAIRING PROCEDURE

Do the same procedure as pairing and takes care of pressing the button previously chosen to define the state »up« of your roller shutter/awning.

RESET PROCEDURE

Relay switch must be power supplied.

1. Press more than 5 seconds on your module's button. The LED blinks orange.
2. Press once again the button (short press) to confirm the reset. If the reset is correct the LED blinks alternatively in red and green and stays green. Start again if necessary.
3. Your module has now its original settings.