

## USER MANUAL

### RELAY SWITCH BC-WE-F1

- Power supply:** 230V AC ~ 50Hz
- Switching capabilities:** 230V AC - 3A
- Consumption:** <1W
- Maximum engine power:** 280W Max - 60 Nm Max
- List of compatible engines available on [www.nodon.fr/loads](http://www.nodon.fr/loads)
- Radio frequency range:** 868.0 to 868.6 Mhz
- RF power Max:** +3dBm
- Range:** up to 30m indoor
- Operational temperature:** -10°C to 40°C
- Protection rating:** IP 30
- Pairing:** up to 22 controllers
- EEP (EnOcean Profile):** D2-05-00
- Dimension:** 40 mm (l) x 44 mm (L) x 16,9 mm (h)
- Weight:** 34 g
- Warranty:** 2 years

#### DANGER OF ELECTROCUTION



BEFORE ANY INSTALLATION MAKE SURE THE POWER SUPPLY IS DISCONNECTED TO AVOID ANY RISK OF ELECTROCUTION.

Directly cut the power supply from the breaker box to avoid any risk of electrocution. This relay switch is designed to be used power up, a wrong installation can create a fire or an electric shock. If you are not confident about electrical installation, please ask a professional.

The relay switch must be installed and connected carefully following the instructions of this user guide. We will not be responsible for any loss or damage resulting from a non-respect of the instructions of this user guide. Cut the power supply before any operation and don't do any modification if the LED is still ON.

#### USE CAUTIONS

- Never use the device if it is not correctly installed and placed inside a connecting box in conformity with the current norms.
- Keep the product far away from liquids.



This product must be used indoor only.



This product is conform to EnOcean radio protocol.



#### INSTALLATION

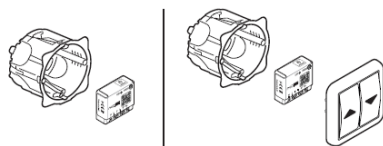

Thanks to its compact size, the Roller Shutter Relay Switch can be installed in a connecting box or behind the wall switch which controls the roller shutter or motorized awning.

#### INSTALLATION DIAGRAM

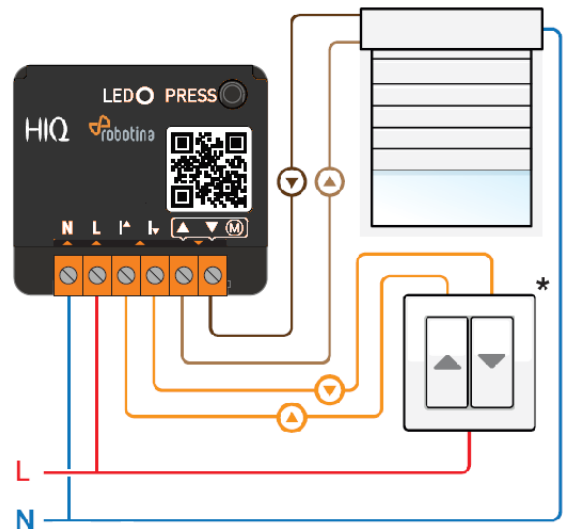

#### AUTO-DETECTION OF SWITCH TYPE

After turning the power supply ON, do a single push on the wired wall switch to bring the roller shutter half-height. The Relay Switch has an auto-detection system to automatically detect the type of wired wall switch (rocker or push-button) wired at the input.

**Note:** The same configuration is applied for both inputs (I+ and I-). It is not possible to combine a rocker switch with a push-button. To perform a new auto-detection, the Roller Shutter Relay Switch must be manually reset (see reset procedure).

#### CALIBRATION OF THE ROLLER SHUTTER RELAY SWITCH

**Relay Switch must be power supplied.**

Two modes:

##### 1. From the Relay Switch



**Note:** The Relay Switch LED blinks green, meaning the calibration has well started.

1 Do 5 short presses.

Or

##### 2. From the wired wall switch

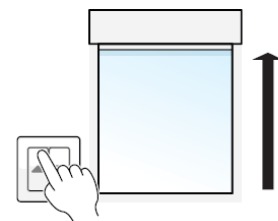

1 Put the roller shutter/awning in position up.

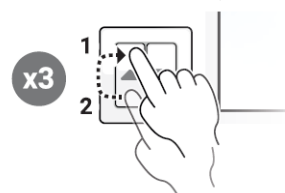

2 Do 3 times the cycle "up - stop" with the wired wall switch.

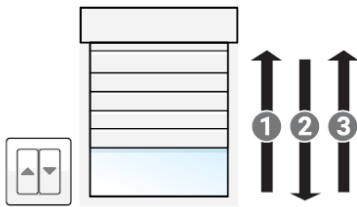

**Cancel the calibration:**  
Perform 5 brief presses. From the wired switch, press once on the switch.

2/3 The roller shutter/awning confirms the auto-calibration by performing a complete cycle "up/down/up" \*\*. \*\* If the cycle is reversed (down/up/down), switch ▲(M) and ▼(M)

## PAIRING THE ROLLER SHUTTER RELAY SWITCH

To add a remote or a wall switch or the Soft Button (EnOcean compatible) you must enter the pairing mode, your light must be switched OFF.  
**Relay Switch must be power supplied.**

Two modes:

### 1. From the Relay Switch

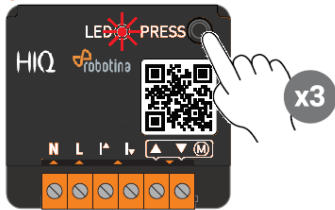

1 Launch the pairing by doing 3 consecutive presses on the button of the Relay Switch. The LED blinks red.

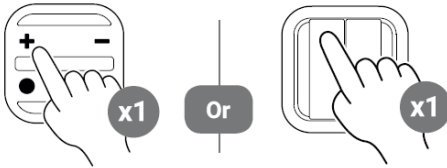

#### 2a Remote or wall switch:

You have now 30 seconds to pair your controller by briefly pressing on the button of your choice (less than a second), this one will control the rise of your roller shutter/awning.

#### 2b Soft Button :

You have now 30 seconds to pair your Soft Button by doing 5 brief consecutive presses on the button.



3 The Relay Switch LED blinks twice green, confirming the pairing.

**Note:** if the LED blinks orange during the pairing procedure, it means that more than 22 controllers are paired and that no more controller can be paired. You must remove one controller to add a new one.

### 2. From the wired wall switch

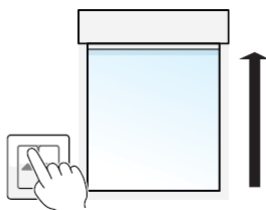

1 Put the roller shutter/awning in position up.

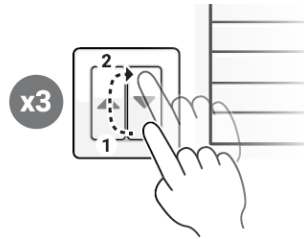

2 Do 3 times the cycle "down - stop" with the wired wall switch.

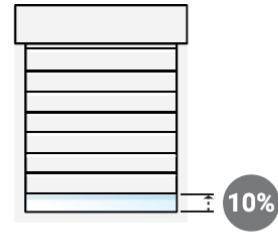

3 The roller shutter/awning will rise of 10%.

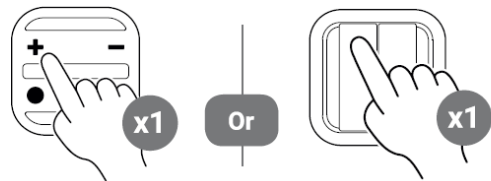

#### 4 Remote or wall switch:

You have 30 seconds to pair your controller by briefly pressing the button of your choice (less than a second), this one will control the rise of your roller shutter/awning.

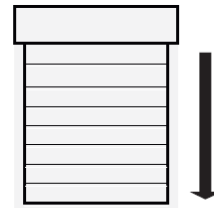

5 The roller shutter/awning confirms the pairing by closing completely.

## UNPAIRING PROCEDURE

Do the same procedure as pairing (see "pairing the Roller Shutter Relay Switch") by taking care of pushing on the button previously chosen to define the state "up" of your roller shutter/awning.

## RESET PROCEDURE

**Relay Switch must be power supplied.**

- 1 Press more than 5 seconds on your Relay Switch's button. The LED blinks orange.
- 2 Press once again the button (short press) to confirm the reset. If the reset is correct, the LED blinks alternatively in red and green and stays green. Start again if necessary.
- 3 Your Relay Switch has now its original settings.